

PRICES 2024

RENTALS

Prices here are not taken into account possible additional discount. Consult our website www.disdille.com to know all about it.

2 ROOMS

LOW SEASON

ARRIVAL et DEPARTURE : Everyday

1 to 4 PERSONS Price / NIGHT

From 19/04 to 28/06
& from 01/09 to 29/09

Except for French days off

2 à 4 nights : > 4 nights : week

French Days-off

Ascension - 3 night minimum
From 08/05 to 12/05

Pentecôte
From 18/05 to 20/05

ÉCOLOGE *

TITHOME *

MOBILHOME LÉMAN *

MOBILHOME EDELWEISS *

MOBILHOME SAVOIE **

MOBILHOME PRM **

MOBILHOME TAOS VIP **

	2 à 4 nights	> 4 nights	week	French Days-off
ÉCOLOGE *	-	-	-	-
TITHOME *	77 €	52 €	364 €	85 €
MOBILHOME LÉMAN *	88 €	58 €	406 €	97 €
MOBILHOME EDELWEISS *	90 €	59 €	413 €	99 €
MOBILHOME SAVOIE **	99 €	66 €	462 €	109 €
MOBILHOME PRM **	99 €	66 €	462 €	109 €
MOBILHOME TAOS VIP **	121 €	88 €	616 €	133 €

3 ROOMS

1 to 6 PERSONS Price / NIGHT

2 à 4 nights : > 4 nights : week

MOBILHOME ALPAGE *

MOBILHOME ALPAGE CLIM *

MOBILHOME TAOS VIP **

	2 à 4 nights	> 4 nights	week	Price / NIGHT
MOBILHOME ALPAGE *	107 €	78 €	546 €	118 €
MOBILHOME ALPAGE CLIM *	118 €	86 €	601 €	130 €
MOBILHOME TAOS VIP **	135 €	99 €	693 €	149 €

HIGH SEASON

ARRIVAL & DEPARTURE *: wednesday/saturday

ARRIVAL & DEPARTURE **: Everyday

1 to 4 PERSONS

Price / week (saturday to saturday)

	29/06 to 05/07	06/07 to 12/07	13/07 to 23/08	24/08 to 31/08
ÉCOLOGE *	427 €	581 €	672 €	427 €
TITHOME *	539 €	742 €	854 €	539 €
MOBILHOME LÉMAN *	616 €	833 €	959 €	616 €
MOBILHOME EDELWEISS *	630 €	861 €	987 €	630 €
MOBILHOME SAVOIE **	700 €	959 €	1099 €	700 €
MOBILHOME PRM **	700 €	959 €	1099 €	700 €
MOBILHOME TAOS VIP **	847 €	1155 €	1400 €	847 €

1 to 6 PERSONS

Price / week (saturday to saturday)

	29/06 to 05/07	06/07 to 12/07	13/07 to 23/08	24/08 to 31/08
MOBILHOME ALPAGE *	749 €	1022 €	1176 €	749 €
MOBILHOME ALPAGE CLIM *	826 €	1127 €	1295 €	826 €
MOBILHOME TAOS VIP **	945 €	1295 €	1512 €	945 €

PROMOS

EARLY BOOKING

- 10% + free booking fees

For booking 1 week minimum done before the 31/01/24.
Not cumulative with Easter Discount
Not applied on the additional fees

EASTER DISCOUNT

- 25%

For one week, mobilhome or pitch Premium, from the 19/04 to the 07/05
(based on the low season price)

LONG STAY DISCOUNT

RENTAL

- 15% + 1 bed linen for 2 prs free
+ WIFI free

CONFORT ET PRIVILEGE PITCHES

- 10% + WIFI free

PREMIUM PITCHES

- 15% + WIFI free

For a stay 18 nights minimum, non cumulative with Easter discount.
Not applied on additional fees.

- 5% From 14 nights

For a stay 14 nights minimum, non cumulative with Easter discount.
Not applied on additional fees.

CAMPING PITCHES

Price per night for :
2 persons + 1 vehicle + 1 caravan or 1 tent

From 19/04 to 30/04

From 01/05 to 29/06

From 30/06 to 12/07

From 13/07 to 24/08

From 25/08 to 31/08

From 01/09 to 29/09

French Days off
Ascension - From 08/05 to 12/05
Pentecôte - From 18/05 to 20/05

Except for French days off

ARRIVAL (2-7pm)
& DEPARTURE (before 12pm)
Everyday

ARRIVAL (2-7pm)
& DEPARTURE (before 10am)
Everyday - Deposit 70€

CONFORT

> 100 m² (10 x 10m)
+ Electricity 10A

PRIVILEGE

> 120 m² (12 x 10m)
+ Electricity 10A
+ water point
+ sewage outlet

PREMIUM
PRIVATE SANITARY &
COVERED TERRACE

> 120 m² (12 x 10m)
+ Electricity 10A
+ water point
+ sewage outlet

23 €

25 €

31 €

37 €

31 €

25 €

31 €

27 €

29 €

35 €

41 €

35 €

29 €

35 €

59 €
2 nights min

64 €
2 nights min

69 €
1 week min





79 €
1 week min

69 €
1 week min





64 €
2 nights min





69 €

CAMPING SERVICES

				
FRIDGE on the pitch	FRIDGE BOX (near the sanitary blocks)	GRILL	SEWAGE OUTLET & WATER FILLING	SANITARY BLOCKS
60 € 1 week 80 € 2 weeks 90 € 3 weeks	3 € 1 Day 15 € 1 week 20 € 2 weeks 25 € 3 weeks	2 € 1 day 10 € 1 week	FREE for guests only	FREE ACCESS for guests only
From 7 nights only	37 liters : (L30 x h24 x P50 cm)	charcoal not included	5 € for visitors	5 Sanitari blocks accessible

RENTAL SERVICES

				
BED SHEETS 1 Person	BED SHEETS 2 Persons	BED SHEETS CHANGE	DISH TOWEL	TOWEL KIT
12 €	15 €	12 € DRAPS 2 pers 10 € DRAPS 1 pers	2 €	6 €
1 pillowcase + sheet + fitted sheet + duvet cover	2 pillowcases + sheet + fitted sheet + duvet cover	From 7 nights	2 disch towels	1 big + 1 small

			
BABY KIT	BABY ACCESSORIES	GRILL	CLEANING for accommodations and Premium pitch
5 € 1 day 20 € 1 week 30 € 2 weeks 40 € 3 weeks	3 € 1 day 15 € 1 week 20 € 2 weeks 25 € 3 weeks	2 € 1 day 10 € 1 week	70 € < 25m ² & PREMIUM 90 € 25 à 34 m ² 120 € > 34 m ²
1 baby bed + 1 baby chair	1 baby bed or 1 baby chair	charcoal not included	depending on the accommodation size

EXTRAS

Price / NIGHT	LOW SEASON	HIGH SEASON
CHILDREN less than 4 y.old	FREE	FREE
CHILDREN from 4 y.old to 10 y.old	4 €	6 €
PERSONS more than 10 y.old	5 €	7 €
DOG <small>1 maximum - Defensive & Attack dogs forbidden cat. 1 et 2) vaccination card mandatory Forbidden in rental in july and August</small>	5 €	8 €
Additional VEHICLE	4 €	5 €
TOURIST TAX / pers + 18 y.old / night	0,5 €	0,5 €
CANCELLATION GUARANTEE	5 % From the stay cost	5 % From the stay cost
BOOKING FEES	FREE	15 €

DEPOSIT ON ARRIVAL* 300€ (rental) + Cleaning fees

2 ROOMS RENTALS DESCRIPTIONS

ECOLOGDE

Model + de 7 y.old

PERS.

1/4

ROOMS

x2

SIZE

19 m²

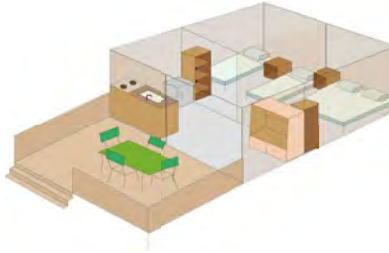

Hut spirit and comfort

- 1 double room : 1 double bed 140 x 190, obsuring curtains/mosquito net,
- 1 child room : 2 single beds 70 x 190, obsuring curtains/mosquito net,
- 1 kitchen : dish, coffee-maker, refrigerator/freezer, microwave, 2 fires cooktop, cold water sink

Covered terrace 10m2 (4 m x 2,5 0 m) with garden table and chairs



From 29/06 to 31/08

No sanitary facilities. Sanitary blocks available 50 m away

TITHOME

Model 3 y.old

PERS.

1/4

ROOMS

x2

SIZE

20 m²

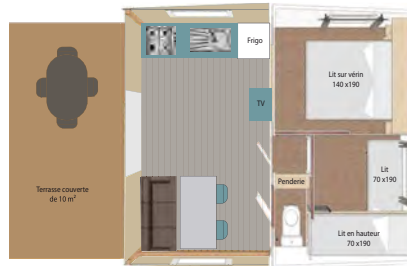

The perfect compromise between an ecolodge and a mobile home

- 1 double room : 1 double bed 140 x 190, obsuring curtains, space heater,
- 1 child room : with bunk beds and truckle bed (70 x 190), obsuring curtains, space heater,
- 1 living room : sofa, TV,
- 1 WC
- 1 kitchen : dish, coffee-maker, refrigerator/freezer, microwave, 4 fires cooktop, cold water sink

Covered terrace 10m2 (4 m x 2,5 0 m) with garden table and chairs



From 29/06 to 31/08

No hot water facilities. Sanitary blocks available 50 m away

MOBILHOME LÉMAN

Model + de 7 y.old

PERS.

1/4

ROOMS

x2

SIZE

29 m²



Mobilhom, interior updated in 2021 - Cot space in parental room

- 1 double room : 1 double bed 140 x 190, obsuring curtains/mosquito net
- 1 child room : 2 single beds 80 x 190, obsuring curtains/mosquito net,
- 1 living room : sofa, space heater, TV,
- 1 shower room : washbasin + shower, WC
- 1 kitchen : dish, coffee-maker, refrigerator/freezer, microwave, 4 fires cooktop

Covered terrace 12m2 (4,80 m x 2,5 0 m) with garden table and chairs



From 29/06 to 31/08

No hot water facilities. Sanitary blocks available 50 m away

2ROOMS RENTALS DESCRIPTIONS

MOBILHOME EDELWEISS

Model + than 7 y.olds

PERS.	ROOMS	SIZE	WC	Shower
1/4	x2	31 m ²	x1	x1

Kitchen opened on terrace, storeroom

- 1 double room : 1 double bed 140 x 190, obsuring curtains/mosquito net,
- 1 child room : 2 single beds 80 x 190, obsuring curtains/mosquito net,
- 1 living room : sofa, space heater, TV
- 1 shower room : washbasin + shower, **WC**
- 1 kitchen : dish, coffee-maker, refrigerator/freezer, microwave, 4 fires cooktop



Covered terrace 15m² (6 m x 2,50 m) with garden table and chairs

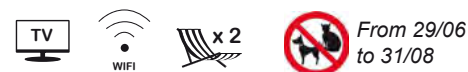

MOBILHOME SAVOIE

Model - than 7 y.old, **air conditioning**

PERS.	ROOMS	SIZE	WC	Shower
1/4	x2	31 m ²	x1	x1

Our best "classical" 2 rooms rental

- 1 double room : 1 double bed 140 x 190, obsuring curtains/mosquito net,
- 1 child room : 2 single beds 80 x 190, obsuring curtains/mosquito net,
- 1 living room : reversible air conditioning, sofa, space heater, TV
- 1 shower room : washbasin + shower, **WC**
- 1 kitchen : dish, coffee-maker, refrigerator/freezer, microwave-oven, 4 fires cooktop

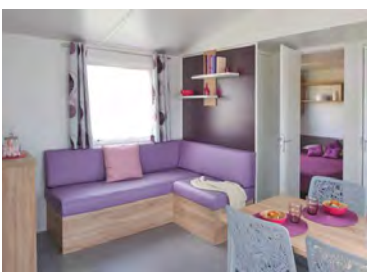

Covered terrace 15m² (6 m x 2,50 m) with garden table and chairs



MOBILHOME PMR

Model + than 7 y.old, **air conditioning**



PERS.	ROOMS	SIZE	WC	Shower
1/4	x2	35 m ²	x1	x1

Mobilhom especially designed for disabled persons

- 1 double room : 1 double bed 160 x 200, obsuring curtains/mosquito net,
- 1 child room : with bunk bed 80 x 190, obsuring curtains/mosquito net,
- 1 living room : reversible air conditioning, sofa, space heater, TV,
- 1 shower room : washbasin + shower, **WC**,
- 1 kitchen : dish, coffee-maker, refrigerator/freezer, microwave, 4 fires cooktop



Covered terrace 15m² (6 m x 2,50 m) with garden table and chairs



MOBILE HOME TAOS VIP 2 CH

Model less than 7 y.old, **air conditioning**

PERS.	ROOMS	SIZE	WC	Shower
1/4	x2	35 m ²	x2	x2



Premium Mobilhome, well laid out

- 1 master suite : 1 double bed 160 x 200, obsuring curtains, shower cabin 120 x 90 cm, independant WC, direct access to the terrace,
- 1 child room : 2 single beds 80 x 190, obsuring curtains/mosquito net, shower cabin 80 x 80, WC,
- 1 living room : reversible air conditioning, sofa, space heater, TV,
- 1 kitchen : dish, dish washer, coffee-maker, refrigerator/freezer, microwave, 4 fires cooktop,

Partially covered terrace 27m² (9 m x 3 m) with garden table and chairs, deckchairs and grill.



Arrival and departure everyday

3 ROOMS RENTALS DESCRIPTIONS

MOBILE HOME ALPAGE

Model from 4 to 12 y.old, **air conditioning, only for model Alpage CLIM**

PERS.	ROOMS	SIZE	WC	Shower
1/6	x3	33 m ²	x1	x1



Mobilhome up to 6 persons, with or without air conditioning

- 1 double room : 1 double bed 140 x 190, obsuring curtains/mosquito net,
- 2 children rooms : 2 x 2 single beds 80 x 190, obsuring curtains/mosquito net,
- 1 living room : sofa, space heater, TV,
- 1 shower room : washbasin + shower, **separated WC**
- 1 kitchen : dish, coffee-maker, refrigerator/freezer, microwave-oven, 4 fires cooktop

Covered terrace 15m² (6 m x 2,50 m) with garden table and chairs, 2 rest seats



Air Conditioning ONLY for model ALPAGE CLIM



From 29/06 to 31/08

MOBILE HOME TAOS VIP 3 CH

Model less than 7 y.old, **air conditioning**

PERS.	ROOMS	SIZE	WC	Shower
1/6	x3	38 m ²	x2	x2



Premium Mobilhome up to 6 pers, well laid out

- 1 master suite : 1 double bed 160 x 200, obsuring curtains, shower cabin 120 x 90 cm, independant WC, direct access to the terrace,
- child room n°1 : 2 single beds 80 x 190, obsuring curtains/mosquito net, access to the shower cabin 80 x 80 and WC
- child room n°2 : 2 bunk bed 80 x 190, obsuring curtains/mosquito net, access to the shower cabin 80 x 80 and WC
- 1 living room : reversible air conditioning, sofa, space heater, TV
- 1 kitchen : dish, dish washer, coffee-maker, refrigerator/freezer, microwave, 4 fires cooktop,

Partially covered terrace 27m² (9 m x 3 m) with garden table and chairs, deckchairs and grill.



Arrival and departure everyday

GENERAL BOOKING CONDITIONS

1. Everybody allowed in the campsite must respect the **Internal Rules under penalty of immediate exclusion without refund.**

The rules are posted up at the entrance and available on demand at the reception desk.

2. **Minors** can stay on the campsite only accompanied by at least one of their relatives or adults who **are shouldering the responsibility.**

If the campsite might allow minors to stay on their own, signed parental release and copy of identity card are mandatory at the arrival.

3. **1 dog only is allowed by emplacement** (updated vaccination book mandatory). It must be kept on a leash and under its owner responsibility.

It must never be let on its own under penalty of immediate exclusion of its owner without refund. **Defensive and attack dogs are strictly forbidden (category I and II).**

4. Booking is **strictly personal** and can under no circumstances be transferred or sublet. To book, client must send the signed reservation form with first-part payment (25% of the stay cost + 15€ of administration fee, **non deductible, non refundable**). Reservation is valid **only** at reception of the confirmation document sent by Saint-Disdille campsite.

5. **MOBIL-HOME / CHALET / FURNISHED TENTS:**

Bookings are for **7 nights minimum in July/August, 2 nights minimum in low season** (except for French National Holidays – see rates details).

Arrivals are between 14h and 19h, **on Wednesday or Saturday in July/August, every day in low season**. For arrival later than 19h, please inform the reception.

The balance of your stay is due 30 days before your arrival date under penalty of automatic cancellation without refund.

The number of persons occupying the accommodation cannot exceed the defined maximum capacity (see the accommodations descriptions).

Deposits : A 300 € deposit will be asked to cover possible damage on the accommodation; another 70 €, 90 € or 120 € deposit will be asked to cover cleaning fee depending on the type of rental.

All formalities, deposits included, are required before handling of the accommodation keys.

Detailed inventory is available in each renting and it's up to you to check it and notified all missing or damaged object at the reception **within 24h after your arrival**.

Departures are before 10h, on Wednesday or Saturday in July/August, every day in low season. Deposits will be refund after checking of accommodation state and cleanliness.

If damages or missing objects are noticed that are not be notified at your arrival their cost will be deducted from the deposit; if the renting is not clean at your departure, cleaning fee will be charged.

For departure outside the opening hours (inform the reception), deposits will be destroyed after check-out (or return by post – provide a postmarked envelope at your name and address).

6. **CAMPING PITCHES:**

Arrivals are between **14h and 19h every day (except for Premium pitch - see rates details)**. For arrival later than 19h, please inform the reception.

The balance of your stay is due on site at your arrival and the deposit for the Premium pitch 70 € as well.

The number of persons occupying a pitch cannot exceed 6 persons. Departures are before 12h every day **(except for Premium pitch - see rates details)**.

An extra night will be charged for departures after noon.

7. In case of delay or modification without written advance notice, the renting or the pitch can be put back to the rent on the next day 14h following your theoretical arrival date.

The total cost of the stay is due anyway. **Late arrival or anticipate departure cannot give rise to reimbursement.**

8. In case of inaccurate declaration of the buyer, the present contract will be cancelled by rights and the campground will keep the payments. Every booking modification (number of persons, dogs, cars...) has to be declared at the arrival and may determine either the adjustment of the contract, or its break and the renunciation of the deposit.

9. **CANCELLATION POLICY :**

Cancellations must be sent by registered letter.

In case of cancellation of your stay, whatever the cause, before **March 1st of the current year, all of the sums paid (excluding administrative fees and the amount of the cancellation guarantee) will be refunded***. Beyond that, you will be retained the deposit if cancellation more than 30 days before arrival or the full amount of the stay if cancellation less than 30 days before your arrival, if you do not show up on this date or in the event of interruption of stay or postponed arrival.

However, a **credit for the sums paid** (excluding administrative fees and the amount of the guarantee) may be offered in the event of a cancellation or interruption of the stay related to:

- illness not known at the time of booking, preventing the movement of one of the participants declared for the stay,
- isolation of the client or of one of the participants in the stay who has been declared as a COVID19 contact case,
- death of a spouse, ascendants or descendants, son-in-law or daughter-in-law, brother, sister, brother-in-law, sister-in-law of one of the participants,
- Administrative, judicial or military summons,
- Dismissal or transfer of the client or his spouse,
- Bankruptcy of the company of which the client is the manager,
- Accident / theft of the vehicle occurring on the direct route to the place of stay.
- Significant material damage affecting the client's own property and imperatively requiring his presence.
- Obtaining after the reservation date of an indefinite contract.

In the event of an interruption of the stay linked to one of the aforementioned events, the amount of the credit will be determined on a pro rata basis for the stay actually consumed (excluding administrative fees and amount of the guarantee). The credit can be used depending on the availability of the campsite, either at another period of the current season, or the following season. The credit is non-transferable, non-refundable and has to be used at one time. If the amount of the postponed stay is lower than the amount of the credit, there is no refund of the difference and the remainder is lost. If the amount is upper, client has to pay the difference. Obtaining a credit note can only be done on presentation of the appropriate supporting documents requested by the campsite.

CANCELLATION GUARANTEE (conditions and procedure available on request or on www.disdille.com)

It is optional and payable in addition to the rental, at the same time as the deposit. **Its amount is 5% of the amount of the stay.** It covers **the reimbursement of the sums paid*** (excluding administrative fees and the amount of the guarantee) in the event of cancellation linked to the following events:

- illness not known at the time of booking, preventing the movement of one of the participants declared for the stay,
- isolation of the client or of one of the participants in the stay who has been declared as a COVID19 contact case,
- death of a spouse, ascendants or descendants, son-in-law or daughter-in-law, brother, sister, brother-in-law, sister-in-law of one of the participants,
- Administrative, judicial or military summons,
- Dismissal or transfer of the client or his spouse,
- Bankruptcy of the company of which the client is the manager,
- Accident / theft of the vehicle occurring on the direct route to the place of stay.
- Significant material damage affecting the client's own property and imperatively requiring his presence.
- Obtaining after the reservation date of an indefinite contract.

In the event of an interruption of the stay linked to one of the aforementioned events, the reimbursement will be made on a pro rata basis for the stay actually consumed (excluding administrative fees and amount of the guarantee).

In the particular case of cancellation imposed by government decisions (COVID19), the Cancellation Guarantee allows the publication of a **credit note** of a value equivalent to the sums paid (excluding administrative fees and amount of the guarantee). This can be used depending on the availability of the campsite, either at another period of the current season, or the following season.

The credit is non-transferable, non-refundable and has to be used at one time. If the amount of the postponed stay is less than the amount of the credit, there is no refund of the difference and the remainder is lost. If the amount is upper, client has to pay the difference.

Cancellations supported by a credit note are:

- administrative closure of the campsite,
- travel limitation to a number of kilometers that does not allow the customer to come to the campsite,
- border closure,
- quarantine on arrival of the customer or on return of the latter to his country.

Beyond the validity period of the credit note, it will be permanently lost.

*All refunds will be made between October and December of the current year only.

10. The signature of the booking form implies that the customer agrees that his coordinates can be used by the campsite for advertising. The customer may request deletion of data from the camping database by sending an email to camping@disdille.com.

11. Explicitly and without any compensation, you authorize Saint-Disdille campsite to use pictures of yourself or your children, taken during your stay, for all kind of documentation and publicity matters of the campsite.

12. The signature of the contract implies that the buyer is aware of the general booking conditions and that he engaged himself in knowledge. In case of litigation, the customer must contact the customer service of the camping to find an amicable solution. In case of disagreement, he will be able to contact a mediator, within a period of one year from the date of the written complaint to the camping. The coordinates of the mediator that may be entered by the customer, are:

CM2C,

- by the Internet : <https://www.cm2c.net/>

- by mail: CM2C - 14 rue Saint Jean - 75017 Paris.

- by phone : 06 09 20 48 86

13. **Right of withdrawal:** In accordance with Article 221-28 of the Consumer Code, the right of withdrawal can't be exercised for non-residential accommodation contracts.